

FOUNDATION PLAN
A-3 SCALE: 1/4"=1'-0"

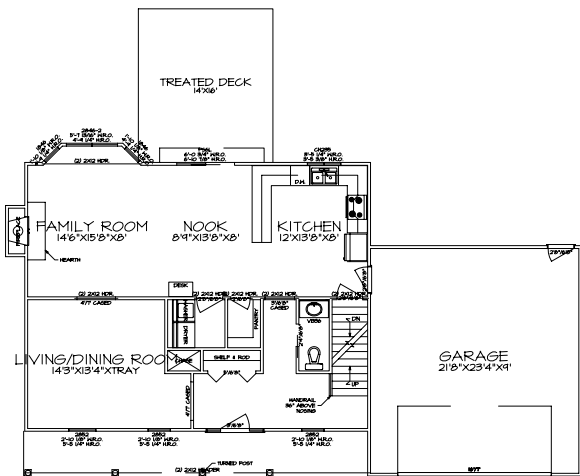

FOUNDATION PLAN NOTES:
 1. ALL FOUNDATION WALLS TO BE CONCRETE
 2. ALL FOUNDATION WALLS TO BE 12" MIN. THICK
 3. ALL FOUNDATION WALLS TO BE 12" MIN. THICK
 4. ALL FOUNDATION WALLS TO BE 12" MIN. THICK
 5. ALL FOUNDATION WALLS TO BE 12" MIN. THICK
 6. ALL FOUNDATION WALLS TO BE 12" MIN. THICK
 7. ALL FOUNDATION WALLS TO BE 12" MIN. THICK
 8. ALL FOUNDATION WALLS TO BE 12" MIN. THICK
 9. ALL FOUNDATION WALLS TO BE 12" MIN. THICK
 10. ALL FOUNDATION WALLS TO BE 12" MIN. THICK

STATISTICS:		D	
AREA:	EXISTING:	PROPOSED:	
FIRST FLOOR AREA:	N/A	1,035 S.F.	
SECOND FLOOR AREA:	N/A	1,024 S.F.	
TOTAL LIVING AREA:	N/A	2,059 S.F.	
SCREENED AREA:	N/A	1,020 S.F.	
GARAGE AREA:	N/A	529 S.F.	
TOTAL AREA:	N/A	3,608 S.F.	



FIRST FLOOR PLAN
A-4 SCALE: 1/4"=1'-0"



FLOOR PLAN NOTES:
 1. ALL WALLS TO BE 1/2\"/>

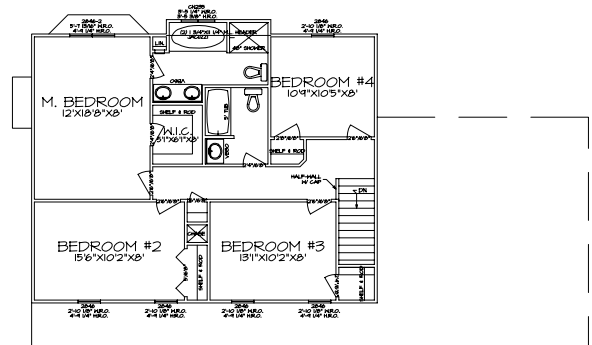

SECOND FLOOR PLAN
A-5 SCALE: 1/4"=1'-0"



FLOOR PLAN NOTES:
 1. ALL WALLS TO BE 1/2\"/>